

Residence Inn by Marriott



**St. Louis, Missouri
2003**

PROJECT OVERVIEW

Adapted to the dense urban setting of a St. Louis business district, this eight-story, concrete frame and Masonry complex, is a joint effort of architect, St. Louis Design Alliance and Dominion Hospitality.

Catering to the business traveler and vacationing family, this 188-room extended-stay hotel offers studio lofts, as well as one and two bedroom suites. Other amenities include a business center, meeting rooms, pool, and an exercise room.



lobby



luxury suite

FLOOR PLAN KEY

- A dining room
- B lounge
- C bar
- D meeting room
- E employee lounge
- F office
- G corridor
- H laundry
- J mechanical
- K building engineer
- L prefunction room
- M meeting room
- N lobby
- O vestibule
- P front desk
- Q offices
- R business center
- S exercise room
- T spa
- U pool
- V electrical
- W kitchen
- X serving area

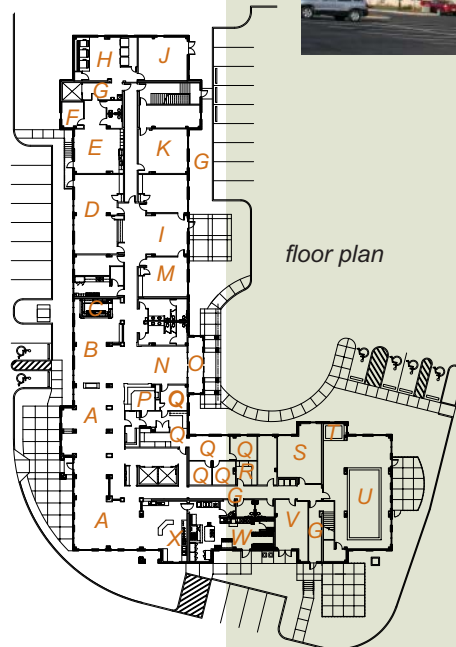

southwest view



pool